

1055nm~1060nm 10mW SM Coaxial Pigtailed Diode Laser with 6um Single Mode Fiber
1060nm | 10mW | SM Fiber Coupled Laser Diode Module (6um SM Fiber)| Built-in PD |SMF LD Module
WSLP-1060-010m-4-PD
Wavespectrum Laser Group
www.wavespectrum-laser.com

1060nm Pigtailed Diode Laser		10mW/SMF		en.wavespectrum-laser.com.cn	
PARAMETER	SYMBOL	VALUE		UNIT	
Reverse Voltage	V_r	2.0		V	
Operating Temperature	T_{op}	-10~+50		°C	
Storage Temperature	T_{stg}	-40~+85		°C	
Lead soldering temperature (10 sec.)	T_{is}	260		°C	
Features: <ul style="list-style-type: none"> ● 1060nm ● 6um Single Mode Fiber ● Coaxial or B82 Package ● Built-in PD 					
Applications: <ul style="list-style-type: none"> ● Medical Laser Treatment ● Sensor ● Others 					
Specifications	WSLP-1060-010m-4-PD				
	Min	Type	Max		
Center Wavelength@25°C	1060nm±10nm				
Recommended Operating Temperature	25°C				
Output Power	----	10mW	----		
Fiber Type	Single Mode Fiber				
Fiber Core	6um				
Monitor Current	----	0.2mA	----		
PD Reverse Voltage	----	----	30V		
Fiber Connector	FC/SC/SMA905				
Fiber Length	>80cm				
Threshold Current (Typ.)	----	25mA	45mA		
Operating Current (Typ.)	----	100mA	120mA		
Operating Voltage	----	1.7V	2.5V		
Package Style	Coaxial or B82				
Photodiodes	Built-in				

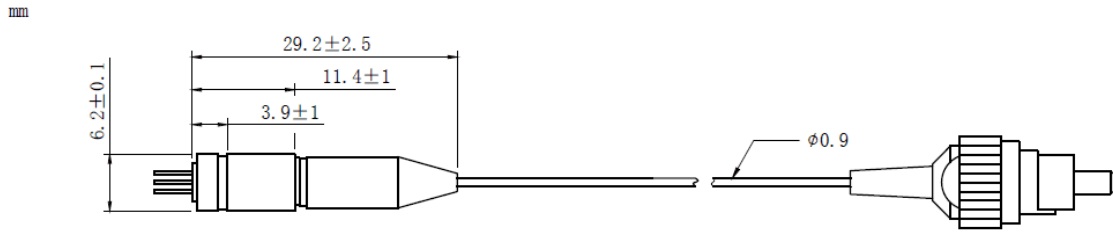

Coaxial Package View: (Part Number: WSLP-1060-010m-4-PD)



B82 Package View: (Part Number: WSLP-1060-010m-4-B-PD)

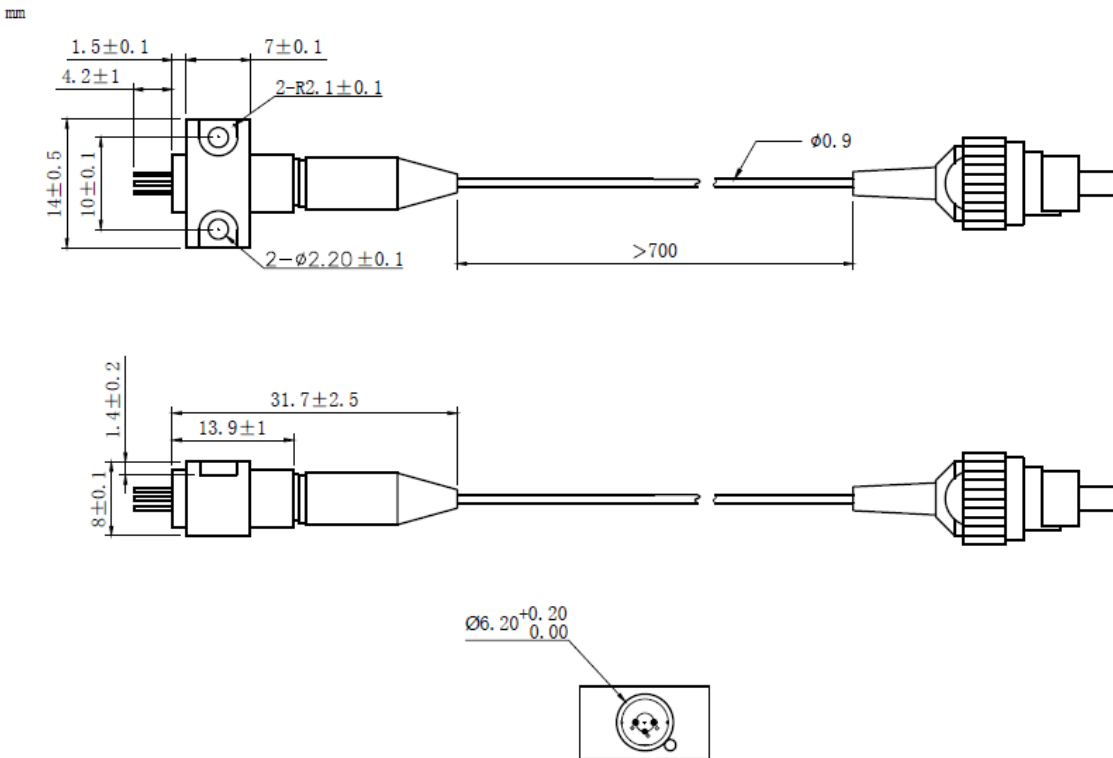

PIN Bottom View:

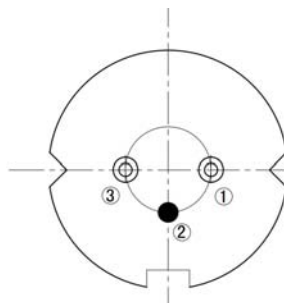

1	LD(-)
2	LD(+)&PD(-)
3	PD(+)



Electrically shorten LD module and store in non-extreme conditions.
Suggest using the constant current power supply.

