

830nm 30mW~35mW High Power SM Fiber Coupled LD with Single Mode Fiber | Built-in Photodiode
830nm 30mW SM Coaxial Pigtailed Laser Diode with SMF | With PD
WSLP-830-030m-4-PD
Wavespectrum Laser Group
www.wavespectrum-laser.com

830nm Pigtailed Diode Laser		30mW/SM Fiber		en.wavespectrum-laser.com.cn	
PARAMETER	SYMBOL	VALUE	UNIT		
Reverse Voltage	V_r	2.0	V		
Operating Temperature	T_{op}	-10~+60	°C		
Storage Temperature	T_{stg}	-40~+85	°C		
Lead soldering temperature (10 sec.)	T_{is}	260	°C		
Features: <ul style="list-style-type: none"> ● 830nm ● With SM Fiber ● Coaxial or B8 Package ● Built-in PD 					
Applications: <ul style="list-style-type: none"> ● Medical Laser Treatment ● Others 					
Specifications	WSLP-830-030m-4-PD				
	Min	Type	Max		
Center Wavelength@25°C	830nm±15nm				
Recommend Operating Temperature	25°C				
Output Power	----	30mW	----		
Fiber Type	Single Mode Fiber				
Fiber Core	5um				
Monitor Current	----	0.3mA	----		
PD Reverse Voltage	----	----	30V		
Fiber Connector	FC/SC/SMA905				
Fiber Length	>80cm				
Threshold Current (Typ.)	----	30mA	60mA		
Operating Current (Typ.)	----	200mA	220mA		
Operating Voltage	----	2.3V	2.8V		
Package Style	Coaxial or B8				
PD	Built-in				

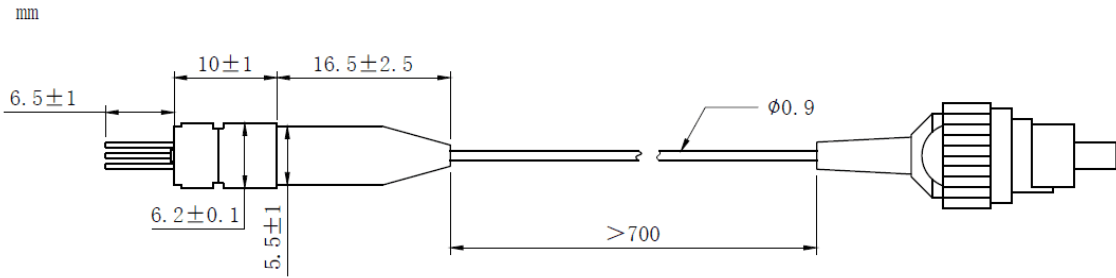
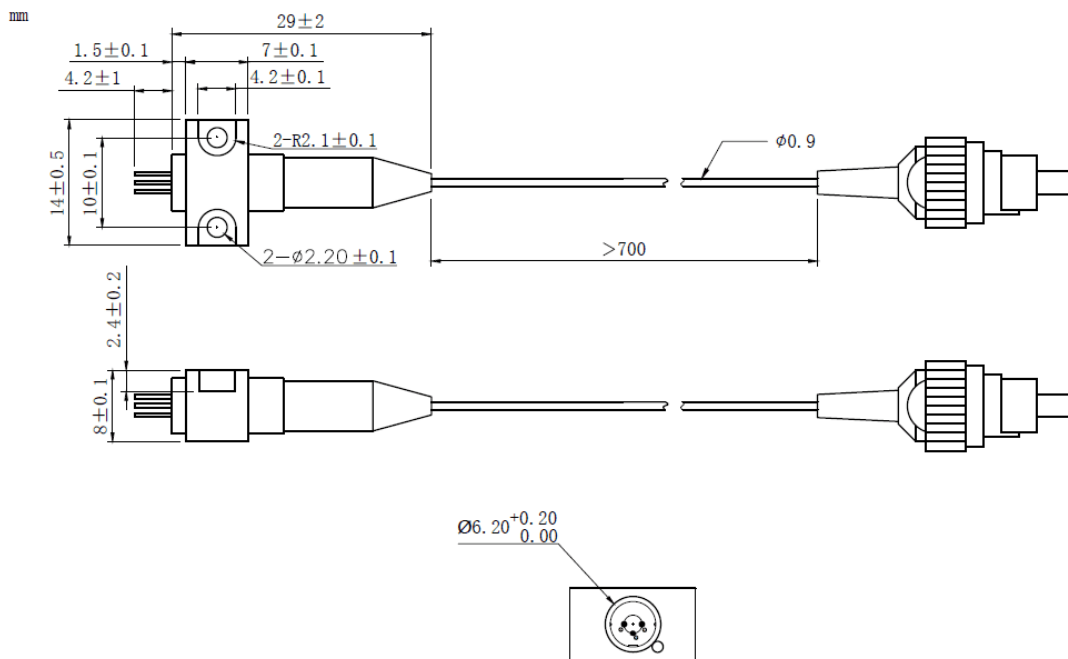
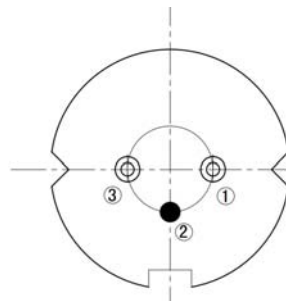

Coaxial Package View: (Part Number: WSLP-830-030m-4-PD)

B8 Package View: (Part Number: WSLP-830-030m-4-B-PD)

PIN Bottom View:

1	LD(-)
2	LD(+)&PD(-)
3	PD(+)



Electrically shorten LD module and store in non-extreme conditions.
Suggest using the constant current power supply.

