

785nm 30mW SM Coaxial Pigtailed Laser Diode Module with SMF | Built-in PD | Heat-sink Optional
780nm~785nm 30mW SM Fiber Coupled LD with Single Mode Fiber (SM Fiber)
WSLP-785-030m-4-PD
Wavespectrum Laser Group
www.wavespectrum-laser.com

785nm Pigtailed Diode Laser		30mW/SM Fiber		en.wavespectrum-laser.com.cn	
PARAMETER	SYMBOL	VALUE		UNIT	
Reverse Voltage	V_r	2.0		V	
Operating Temperature	T_{op}	-10~+60		°C	
Storage Temperature	T_{stg}	-40~+85		°C	
Lead soldering temperature (10 sec.)	T_{is}	260		°C	
Features: <ul style="list-style-type: none"> ● 785nm ● SM Fiber ● Coaxial or B82 Package ● Built-in PD 					
Applications: <ul style="list-style-type: none"> ● Medical Laser Treatment ● Others 					
Specifications		WSLP-785-030m-4-PD			
		Min	Type	Max	
Center Wavelength@25°C		785nm±15nm			
Recommended Operating Temperature		25°C			
Output Power		----	30mW	----	
Fiber Type		Single Mode Fiber			
Fiber Core		5um			
Monitor Current		----	0.3mA	----	
PD Reverse Voltage		----	----	30V	
Fiber Connector		FC/SC/SMA905			
Fiber Length		>80cm			
Threshold Current (Typ.)		----	30mA	55mA	
Operating Current (Typ.)		----	140mA	160mA	
Operating Voltage		----	2.1V	2.6V	
Package Style		Coaxial or B82			
PD		Built-in			

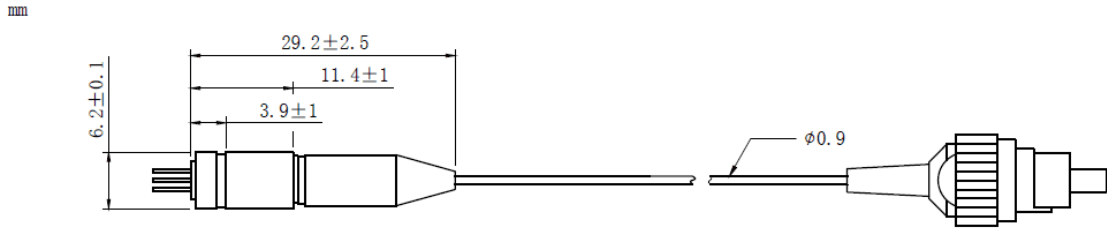
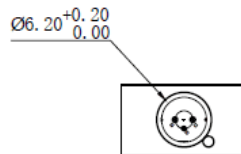
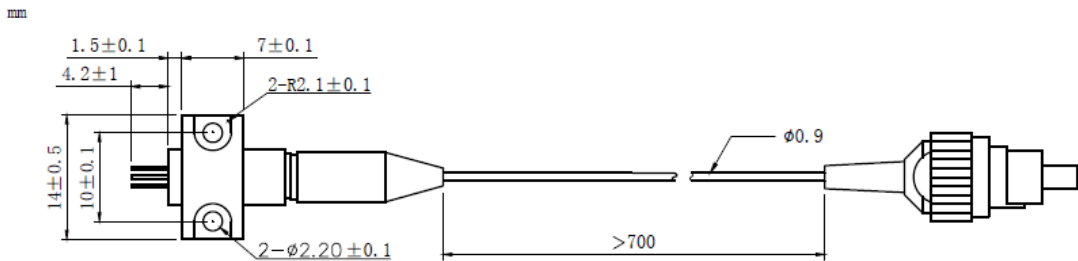
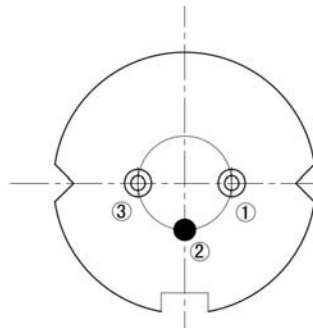

Coaxial Package View: (Part Number: WSLP-785-030m-4-PD)

B82 Package View: (Part Number: WSLP-785-030m-4-B-PD)

PIN Bottom View:

1	LD(-)
2	LD(+)&PD(-)
3	PD(+)



Electrically shorten LD module and store in non-extreme conditions.
Suggest using the constant current power supply.

