

520nm Green 30mW MM Coaxial Fiber Coupled Laser Diode with MMF| Built-in Photodiode
515nm~520nm~530nm MM Pigtailed LD with 105um 50um 62.5um| With PD

WSLP-520-030m-M-PD

Wavespectrum Laser Group

www.wavespectrum-laser.com

520nm Pigtailed Diode Laser		30mW/MMF		Wavespectrum Laser Group	
PARAMETER	SYMBOL	VALUE		UNIT	
Reverse Voltage	V_r	2.0		V	
Operating Temperature	T_{op}	-10~+60		°C	
Storage Temperature	T_{stg}	-40~+85		°C	
Lead soldering temperature (10 sec.)	T_{is}	260		°C	
Features: <ul style="list-style-type: none"> 🔸 520nm Green Diode Laser 🔸 With MM Fiber 🔸 Coaxial or B82 Package 🔸 Built-in Photodiode 					
Applications: <ul style="list-style-type: none"> 🔸 Medical Laser Treatment 🔸 Others 					
Specifications	WSLP-520-030m-M-PD				
	Min	Type	Max		
Center Wavelength@25°C	520nm+/-10nm				
Spectral Width (FWHM)	----	2.0nm	----		
Output Power	----	30mW	----		
Fiber Type	Multimode Fiber				
Fiber Core	105um (50um, 62.5um Optional)				
PD Current	100uA				
Recommend Operating Temperature	25°C				
Fiber Connector	FC/SC/SMA905				
Fiber Length	>80cm				
Threshold Current (Typ.)	----	40mA	80mA		
Operating Current (Typ.)	----	160mA	180mA		
Operating Voltage	----	7.0V	8.0V		
Package Style	Coaxial or B82				
Photodiode	Built-in				

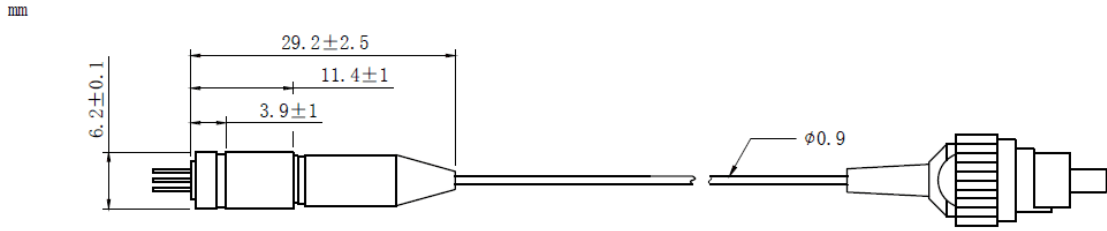
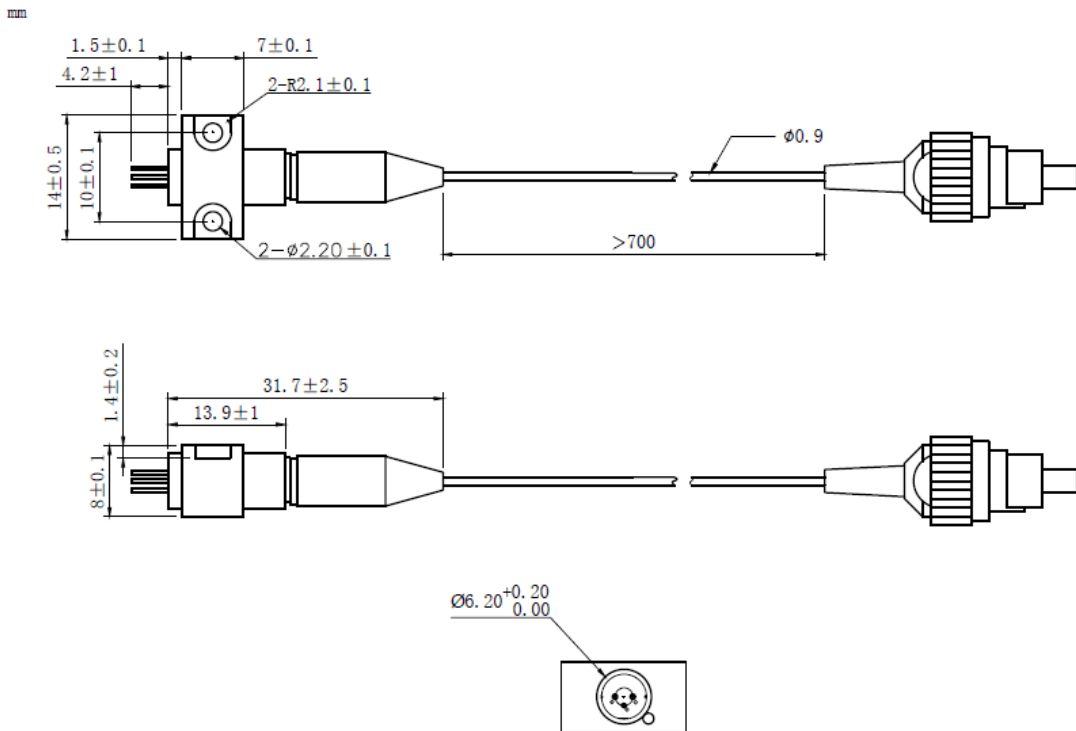
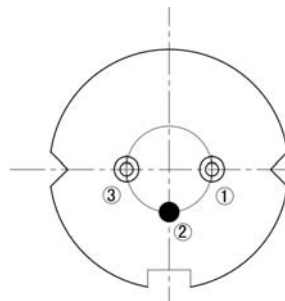

Coaxial Package View: (Part Number: WSLP-520-030m-M-PD)

B82 Package View: (Part Number: WSLP-520-030m-M-B-PD)

PIN Bottom View:

1	LD(-)
2	LD(+)&PD(-)
3	PD(+)



Electrically shorten LD module and store in non-extreme conditions.
Suggest using the constant current power supply.

