

830nm 150mW Coaxial Pigtailed Laser Diode Module | With Photodiode | Heat-sink Optional
830nm 150mW Fiber Coupled LD with MMF| Built-in PD| 105um MM Fiber
WSLP-830-150m-M-PD
Wavespectrum Laser Group
www.wavespectrum-laser.com

830nm Pigtailed Diode Laser	150mW/MMF	en.wavespectrum-laser.com.cn
------------------------------------	------------------	-------------------------------------

PARAMETER	SYMBOL	VALUE	UNIT
Reverse Voltage	V_r	2.0	V
Operating Temperature	T_{op}	-10~+50	°C
Storage Temperature	T_{stg}	-40~+85	°C
Lead soldering temperature (10 sec.)	T_{is}	260	°C

Features: <ul style="list-style-type: none"> 830nm MM Fiber Coaxial or B82 Package Built-in Photodiode 	
Applications: <ul style="list-style-type: none"> Medical Laser Treatment Others 	

Specifications	WSLP-830-150m-M-PD		
	Min	Type	Max
Center Wavelength@25°C	830nm±15nm		
Spectral Width (FWHM)	----	3nm	----
Output Power	----	150mW	----
Fiber Core	105um (62.5um Optional)		
Recommended Operating Temperature	25°C		
Monitor Current	----	0.5mA	----
PD Reverse Voltage	----	----	30V
Fiber Connector	FC/SC/SMA905		
Fiber Length	>80cm		
Threshold Current (Typ.)	----	30mA	65mA
Operating Current (Typ.)	----	230mA	250mA
Operating Voltage	----	2.5V	3.0V
Package Style	Coaxial or B82		



Coaxial Package View: (Part Number: WSLP-830-150m-M-PD)

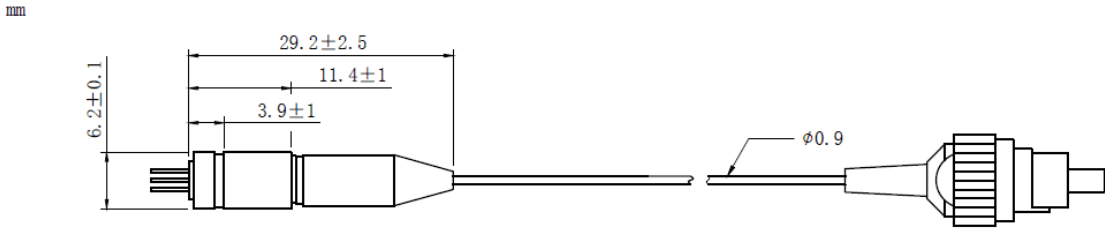

B82 Package View: (Part Number: WSLP-830-150m-M-B-PD)

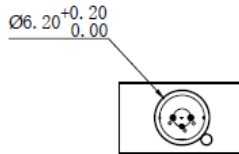
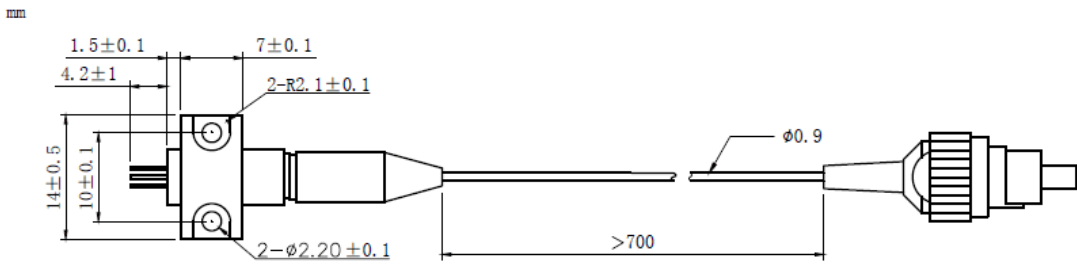

PIN Bottom View:

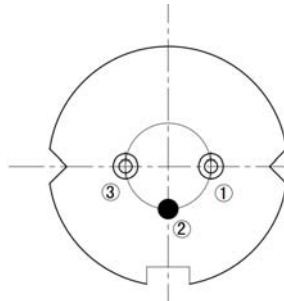

1	LD(-)
2	LD(+)&PD(-)
3	PD(+)



Electrically shorten LD module and store in non-extreme conditions.
Suggest using the constant current power supply.

