

905nm 150mW Multi-mode Pigtailed Laser Diode with Coaxial Package | Built-in Photodiode
905nm~915nm MM Fiber Coupled LD with Multi-mode Fiber | 50um, 62.5um, 105um Optional | With PD
WSLP-905-150m-M-PD
Wavespectrum Laser Group
www.wavespectrum-laser.com

905nm Pigtailed Diode Laser		150mW/MM Fiber		Wavespectrum Laser Group	
PARAMETER	SYMBOL	VALUE		UNIT	
Reverse Voltage	V_r	2.0		V	
Operating Temperature	T_{op}	-10~+60		°C	
Storage Temperature	T_{stg}	-40~+85		°C	
Lead soldering temperature (10 sec.)	T_{is}	260		°C	
Features: <ul style="list-style-type: none"> 905nm Multi-mode Fiber Coaxial or B82 Package Built-in PD 					
Applications: <ul style="list-style-type: none"> Medical Laser Treatment Sensor Others 					
Specifications		WSLP-905-150m-M-PD			
		Min	Type	Max	
Center Wavelength@25°C		905nm±10nm			
Recommend Operating Temperature		25°C			
Output Power		----	150mW	----	
Fiber Type		Multi-mode			
Fiber Core		105um(50um,200um Optional)			
Monitor Current		----	0.3mA	----	
PD Reverse Voltage		----	----	30V	
Fiber Connector		FC/SC/SMA905			
Fiber Length		>80cm			
Threshold Current (Typ.)		----	30mA	70mA	
Operating Current (Typ.)		----	240mA	260mA	
Operating Voltage		----	2.2V	2.8V	
Package Style		Coaxial or B82			
Photodiodes		Built-in			

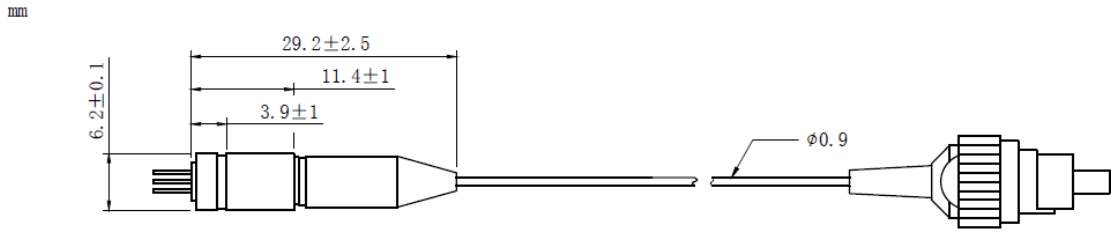
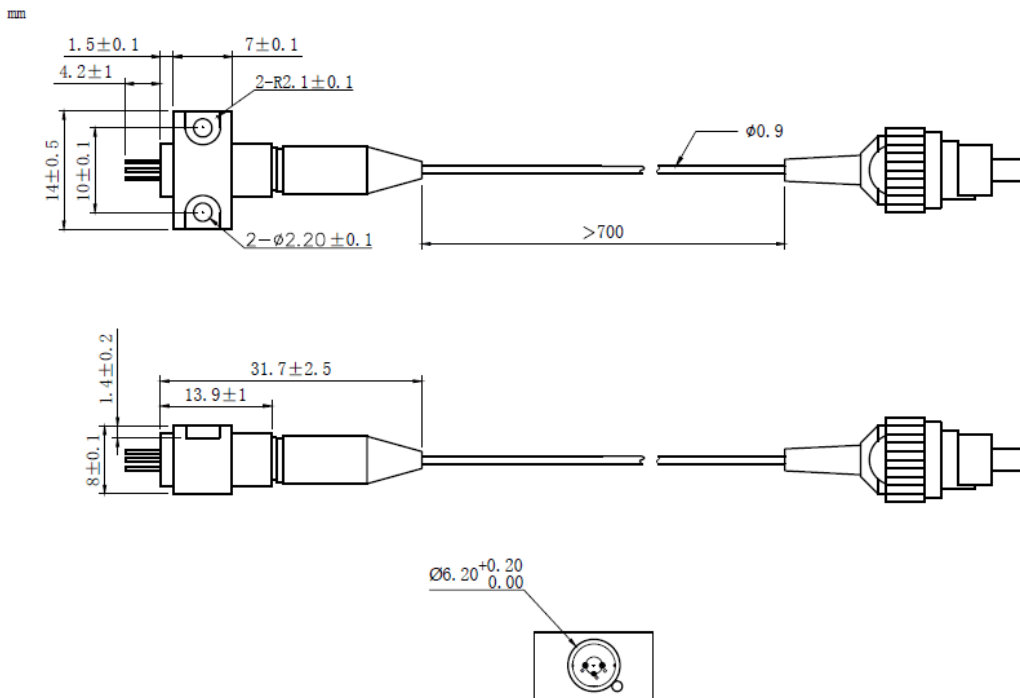
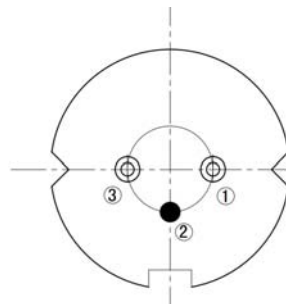

Coaxial Package View: (Part Number: WSLP-905-150m-M-PD)

B82 Package View: (Part Number: WSLP-905-150m-M-B-PD)

PIN Bottom View:

1	LD(-)
2	LD(+)&PD(-)
3	PD(+)



Electrically shorten LD module and store in non-extreme conditions.
Suggest using the constant current power supply.

