

**905nm 100mW~120mW Multi-mode Pigtailed Laser Diode with Coaxial Package | Built-in Photodiode**  
**905nm~915nm MM Fiber Coupled LD with Multi-mode Fiber | 50um, 62.5um, 105um Optional | With PD**  
**WSLP-905-120m-M-PD**                      **Wavespectrum Laser Group**                      **www.wavespectrum-laser.com**

905nm Pigtailed Diode Laser		120mW/MM Fiber		Wavespectrum Laser Group	
PARAMETER	SYMBOL	VALUE		UNIT	
Reverse Voltage	$V_r$	2.0		V	
Operating Temperature	$T_{op}$	-10~+60		°C	
Storage Temperature	$T_{stg}$	-40~+85		°C	
Lead soldering temperature (10 sec.)	$T_{is}$	260		°C	
<b>Features:</b> <ul style="list-style-type: none"> <li>● 905nm</li> <li>● Multi-mode Fiber</li> <li>● Coaxial or B82 Package</li> <li>● Built-in PD</li> </ul>					
<b>Applications:</b> <ul style="list-style-type: none"> <li>● Medical Laser Treatment</li> <li>● Sensor</li> <li>● Others</li> </ul>					
<b>Specifications</b>	<b>WSLP-905-120m-M-PD</b>				
	Min	Type	Max		
Center Wavelength@25°C	905nm±10nm				
Recommend Operating Temperature	25°C				
Output Power	100mW	120mW	----		
Fiber Type	Multi-mode				
Fiber Core	105um(50um,200um Optional)				
Monitor Current	----	0.3mA	----		
PD Reverse Voltage	----	----	30V		
Fiber Connector	FC/SC/SMA905				
Fiber Length	>80cm				
Threshold Current (Typ.)	----	30mA	65mA		
Operating Current (Typ.)	----	220mA	240mA		
Operating Voltage	----	2.0V	2.6V		
Package Style	Coaxial or B82				
Photodiodes	Built-in				

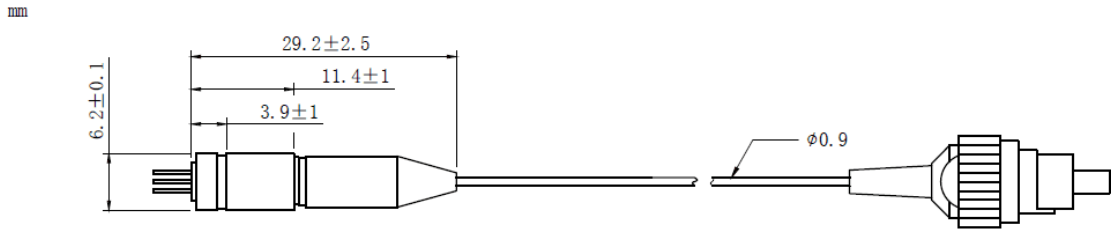
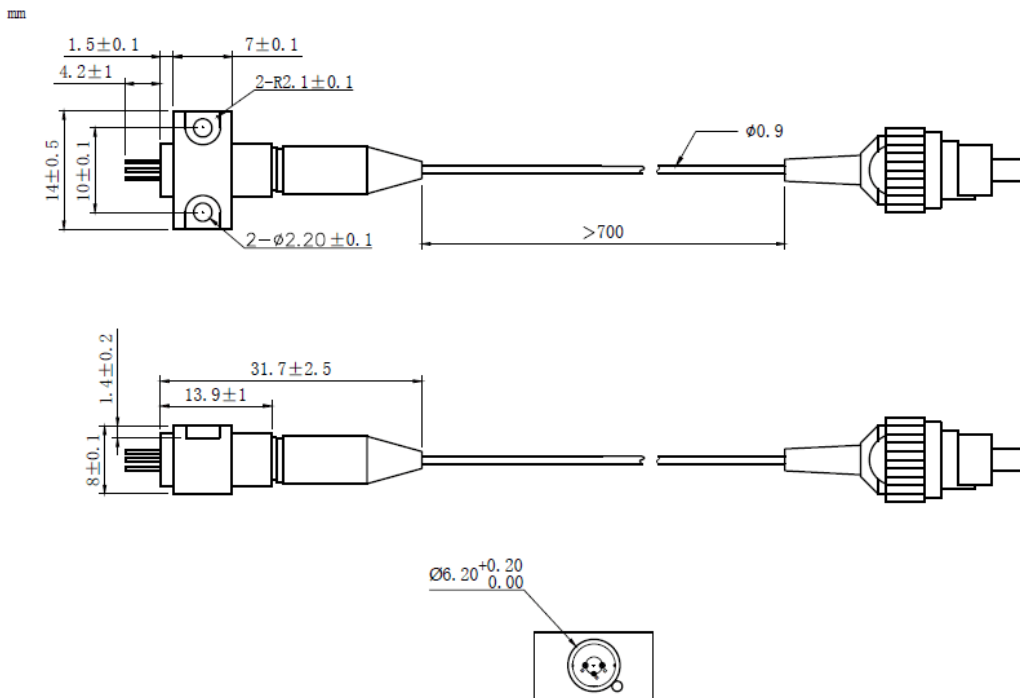
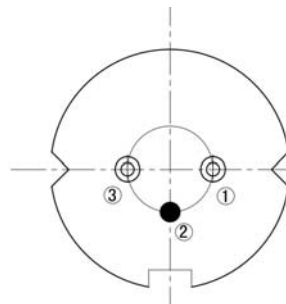

**Coaxial Package View: (Part Number: WSLP-905-120m-M-PD)**

**B82 Package View: (Part Number: WSLP-905-120m-M-B-PD)**

**PIN Bottom View:**

<b>1</b>	<b>LD(-)</b>
<b>2</b>	<b>LD(+)&amp;PD(-)</b>
<b>3</b>	<b>PD(+)</b>



Electrically shorten LD module and store in non-extreme conditions.  
Suggest using the constant current power supply.

