

**635nm~638nm 80mW Single Mode Fiber Coupled Diode Laser with Photodiode (PD)**
**635nm 80mW Coaxial Pigtailed Laser Diode with 4um Single Mode Fiber (SM Fiber)**

WSLP-635-080m-4-PD

Wavespectrum Laser Group

[www.wavespectrum-laser.com](http://www.wavespectrum-laser.com)

635nm Pigtailed Diode Laser		80mW/SMF		<a href="http://en.wavespectrum-laser.com.cn">en.wavespectrum-laser.com.cn</a>	
PARAMETER	SYMBOL	VALUE	UNIT		
Reverse Voltage	$V_r$	2.0	V		
Operating Temperature	$T_{op}$	-10~+60	°C		
Storage Temperature	$T_{stg}$	-40~+85	°C		
Lead soldering temperature (10 sec.)	$T_{is}$	260	°C		
<b>Features:</b> <ul style="list-style-type: none"> <li>● 635nm</li> <li>● 4um SM Fiber</li> <li>● Coaxial or B82 Package</li> <li>● Built-in PD</li> </ul>					
<b>Applications:</b> <ul style="list-style-type: none"> <li>● Medical Laser Treatment</li> <li>● Aiming Beam</li> <li>● Others</li> </ul>					
<b>Specifications</b>	<b>WSLP-635-080m-4-PD</b>				
	Min	Type	Max		
Center Wavelength@25°C	630nm	638nm	645nm		
Recommended work Temperature	25°C				
Output Power	----	80mW	----		
Fiber Type	Single Mode Fiber				
Fiber Core	4um				
Monitor Current	----	0.3mA	----		
PD Reverse Voltage	----	----	30V		
Fiber Connector	FC/SC/SMA905				
Fiber Length	----	80cm	100cm		
Threshold Current	----	60mA	90mA		
Operating Current	----	260mA	280mA		
Operating Voltage	----	2.8V	3.5V		
Package Style	Coaxial or B82				
PD	Built-in				

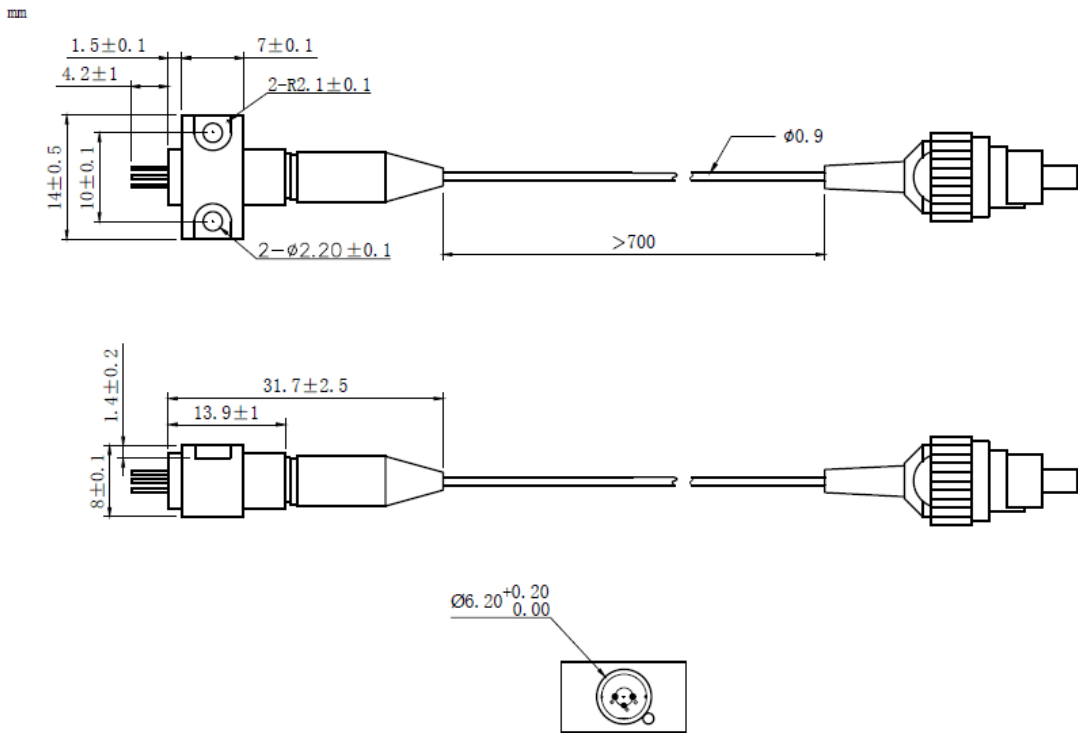
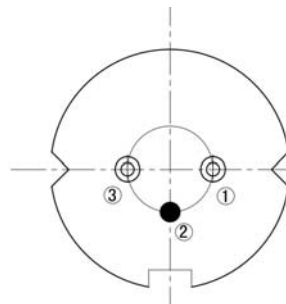

**Coaxial Package View: (Part Number: WSLP-635-080m-4-PD)**

**B82 Package View: (Part Number: WSLP-635-080m-4-B-PD)**

**PIN Bottom View:**

1	LD(-)
2	LD(+)&PD(-)
3	PD(+)



Electrically shorten LD module and store in non-extreme conditions.  
Suggest using the constant current power supply.

