

510nm 20mW SM Coaxial Fiber Coupled Laser Diode with SMF | Green LD Module
505nm~510nm 20mW SM Pigtailed LD with Single Mode Fiber (SM Fiber)

WSLP-510-020m-4

Wavespectrum Laser Group

www.wavespectrum-laser.com

| 510nm Pigtailed Diode Laser | | 20mW/SM Fiber | | en.wavespectrum-laser.com.cn | |
|--|--|---------------|-------|--|--|
| PARAMETER | SYMBOL | VALUE | | UNIT | |
| Reverse Voltage | V_r | 2.0 | | V | |
| Operating Temperature | T_{op} | -10~+60 | | °C | |
| Storage Temperature | T_{stg} | -40~+85 | | °C | |
| Lead soldering temperature (10 sec.) | T_{is} | 260 | | °C | |
| Features: <ul style="list-style-type: none"> 🔸 510nm Green Diode Laser 🔸 3um SM Fiber 🔸 Coaxial or B82 Package |  | | | | |
| Applications: <ul style="list-style-type: none"> 🔸 Medical Laser Treatment 🔸 Others | | | | | |
| Specifications | WSLP-510-020m-4 | | | | |
| | Min | Type | Max | | |
| Center Wavelength@25°C | 510nm±10nm | | | | |
| Spectral Width (FWHM) | ---- | 2.0nm | ---- | | |
| Output Power | ---- | 20mW | ---- | | |
| Fiber Type | Single Mode Fiber | | | | |
| Fiber Core | 3um | | | | |
| Recommend Operating Temperature | 25°C | | | | |
| Fiber Connector | FC/SC/SMA905 | | | | |
| Fiber Length | >80cm | | | | |
| Threshold Current | ---- | 55mA | 95mA | | |
| Operating Current | ---- | 220mA | 240mA | | |
| Operating Voltage | ---- | 7.5V | 8.0V | | |
| Package Style | Coaxial or B82 | | | | |
| | | | | | |

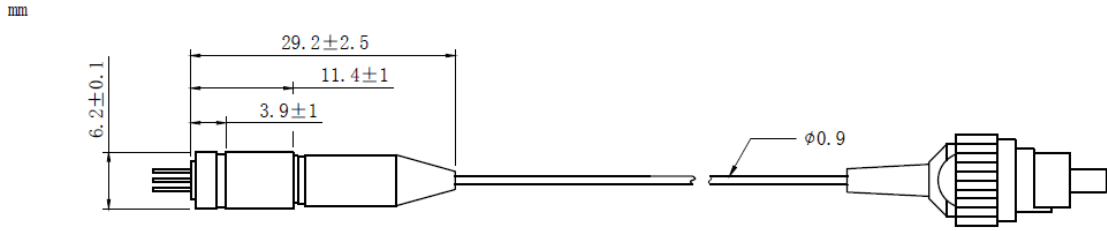
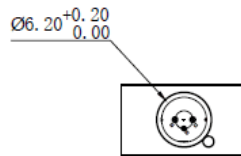
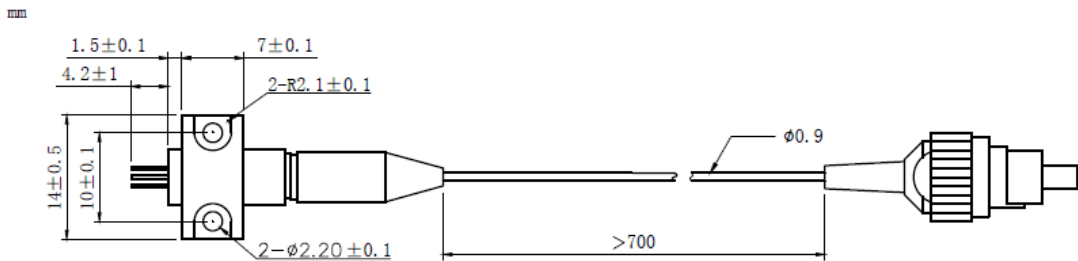
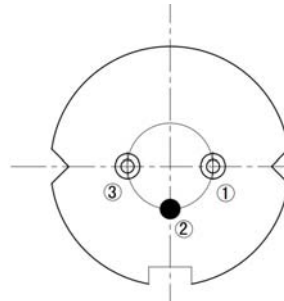

Coaxial Package View: (Part Number: WSLP-510-020m-4)

B82 Package View: (Part Number: WSLP-510-020m-4-B)

PIN Bottom View:

| | |
|----------|--------------|
| 1 | LD(+) |
| 2 | GND |
| 3 | LD(-) |



Electrically shorten LD module and store in non-extreme conditions.
Suggest using the constant current power supply.

