

658nm~660nm 50mW~60mW SM Fiber Coupled Laser Diode with 4um Single Mode Fiber
 660nm 50mW Pigtailed Diode Laser with Coaxial Package | High Power SM Red LD Module
 WSLP-660-050m-4 Wavespectrum Laser Group www.wavespectrum-laser.com

www.wavespectrum-laser.com

660nm Pigtailed Diode Laser		50mW/SM Fiber		en.wavespectrum-laser.com.cn	
PARAMETER	SYMBOL	VALUE	UNIT		
Reverse Voltage	V_r	2.0	V		
Operating Temperature	T_{op}	-10~+60	°C		
Storage Temperature	T_{stg}	-40~+85	°C		
Lead soldering temperature (10 sec.)	T_{is}	260	°C		
Features: <ul style="list-style-type: none"> 660nm Single Mode Fiber Coaxial or B8 Package 					
Applications: <ul style="list-style-type: none"> Medical Laser Treatment Other 					
Specifications	WSLP-660-050m-4				
	Min	Type	Max		
Center Wavelength@25°C	660nm±10nm				
Spectral Width (FWHM)	----	2.0nm	----		
Output Power	----	50mW	----		
Fiber Type	Single Mode Fiber				
Fiber Core	4um				
Recommend Operating Temperature	25°C				
Fiber Connector	FC/SC/SMA905				
Fiber Length	>80cm				
Threshold Current	----	55mA	75mA		
Operating Current	----	200mA	220mA		
Operating Voltage	----	2.8V	3.5V		
Package Style	Coaxial or B8				

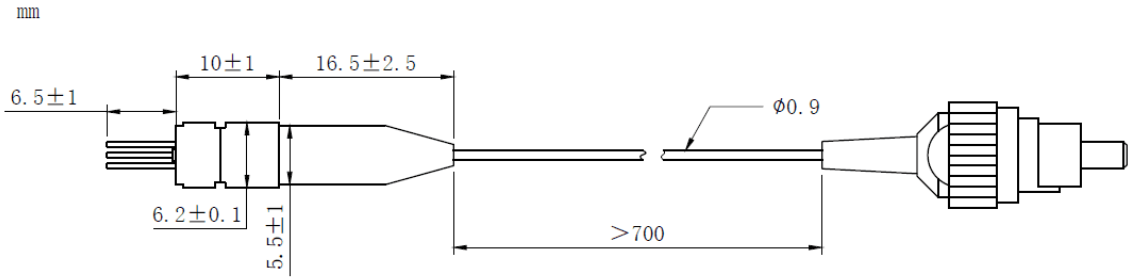
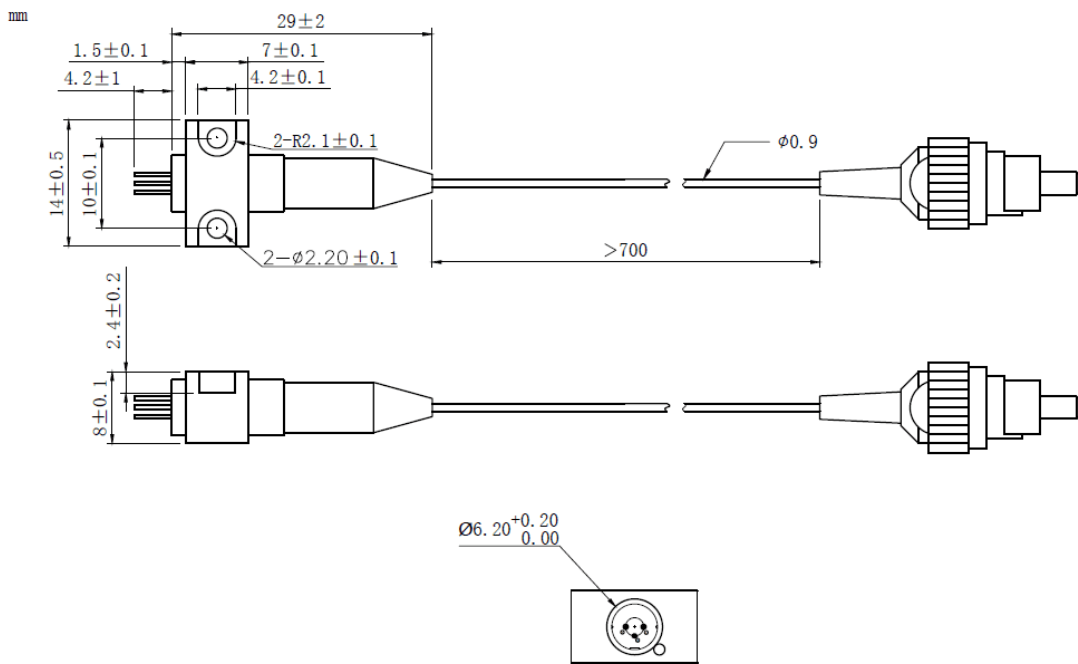
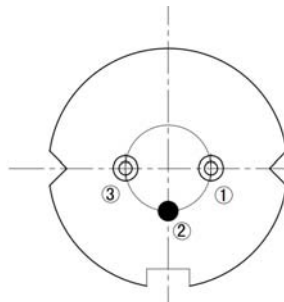

Coaxial Package View: (Part Number: WSLP-660-050m-4)

B8 Package View: (Part Number: WSLP-660-050m-4-B)

PIN Bottom View:

1	LD(+)
2	LD(-)
3	NC



Electrically shorten LD module and store in non-extreme conditions.
Suggest using the constant current power supply.

