

520nm 10mW SM Coaxial Fiber Coupled Laser Diode with SMF| Built-in Photodiode
515nm~520nm~530nm SM Pigtailed Green LD with Single Mode Fiber (SM Fiber) | With PD
WSLP-520-010m-4-PD Wavespectrum Laser Group www.wavespectrum-laser.com

www.wavespectrum-laser.com

520nm Pigtailed Diode Laser		10mW/SMF		en.wavespectrum-laser.com.cn	
PARAMETER	SYMBOL	VALUE	UNIT		
Reverse Voltage	V_r	2.0	V		
Operating Temperature	T_{op}	-20~+60	°C		
Storage Temperature	T_{stg}	-40~+85	°C		
Lead soldering temperature (10 sec.)	T_{is}	260	°C		
Features: <ul style="list-style-type: none"> ● 520nm Green Diode Laser ● 3um SM Fiber ● Coaxial or B82 Package ● Built-in Photodiode 					
Applications: <ul style="list-style-type: none"> ● Medical Laser Treatment ● Others 					
Specifications	WSLP-520-010m-4-PD				
	Min	Type	Max		
Center Wavelength@25°C	+/-5nm	520nm	+/-10nm		
Spectral Width (FWHM)	----	2.0nm	----		
Output Power	----	10mW	----		
Fiber Type	Single Mode Fiber				
Fiber Core	3um				
PD Current	100uA				
Recommend Operating Temperature	25°C				
Fiber Connector	FC/SC/SMA905				
Fiber Length	----	80cm	100cm		
Threshold Current	----	40mA	75mA		
Operating Current	----	180mA	200mA		
Operating Voltage	----	7.5V	8.0V		
Package Style	Coaxial or B82				
Photodiode	Built-in				

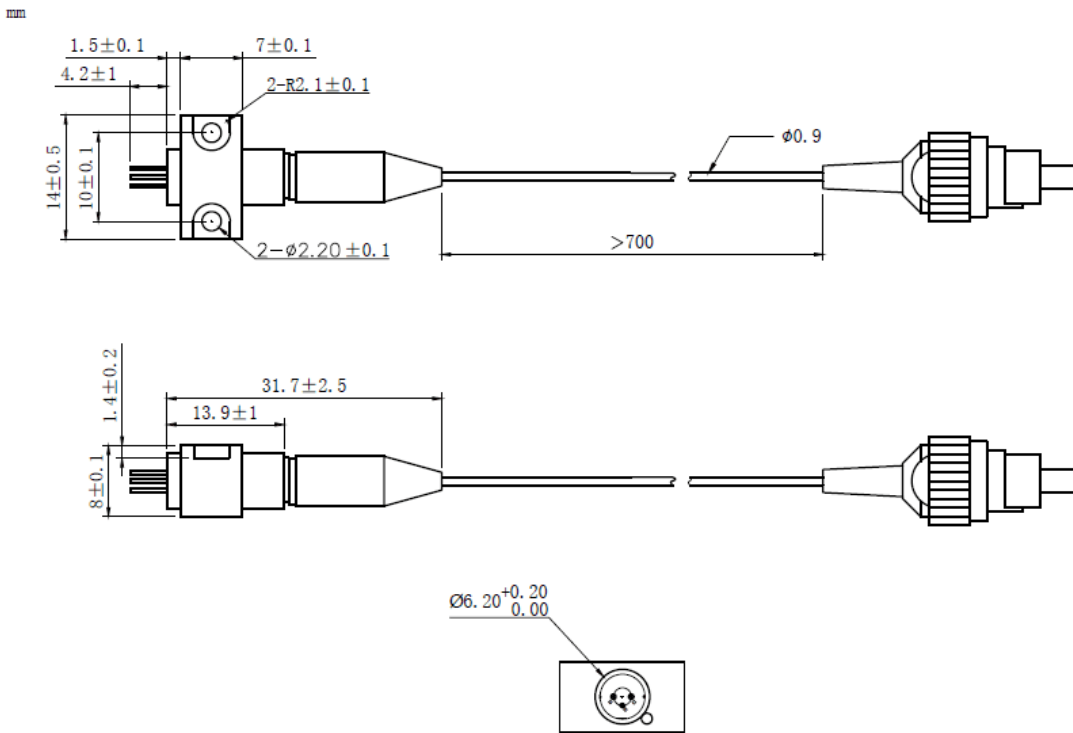
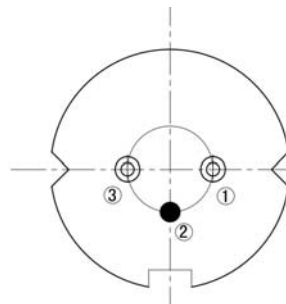

Coaxial Package View: (Part Number: WSLP-520-010m-4-PD)

B82 Package View: (Part Number: WSLP-520-010m-4-B-PD)

PIN Bottom View:

1	LD(-)
2	LD(+)&PD(-)
3	PD(+)



Electrically shorten LD module and store in non-extreme conditions.
Suggest using the constant current power supply.

